

CATALOG FERONERIE PENTRU MOBILA

Finisaje

Ni - nichelat
 Nisat - nichel satinat
 Cr - cromat
 Crsat - crom satinat
 Al - alămit lucios

ZI - zincat irizat
 ZA - zincat albastru
 AAL1 - patinat pe alamă antic
 CN - patinat pe cupru negru
 CMR - patinat pe cupru maro roșcat
 Vopsit cu pulbere în câmp electrostatic
 - culori conform catalogului RAL



Sensul de montaj pentru broaște și balamale

Stânga



Dreapta





001-38/37
a=25



001-41
a=15



001-52/53
a=15



001-54



001-63/64
a=20



013-28 a=19



010-52..57/66/67
a=15/20/25/30



010-68
a=12,5



041-19/20 a=25



001-33



001-46



001-74



001-75/76



001-47



001-50



756-01



756-05



756-02



756-06



800-01



10000720/10000721



140-08



10000718



110-18



110-23



765-19 L=34



765-27 L=41



765-31 L=40



765-33 L=35,5

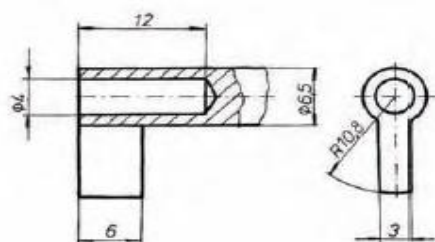

765-46 L=35



765-67 L=32,5



765-35 L=40



765-84 L=40



765-96 L=34
765-97 L=40



765-102 L=40



773-50



773-60



773-98



773-99



767-43



773-62



767-52



773-34



757-35



600-09



600-28



600-60



757-11



600-91



600-51



600-105



600-112



600-136



600-141



600-142



645-46



645-29



625-05



625-06



645-27



625-37



625-36



645-07 L=95



645-28 L=85

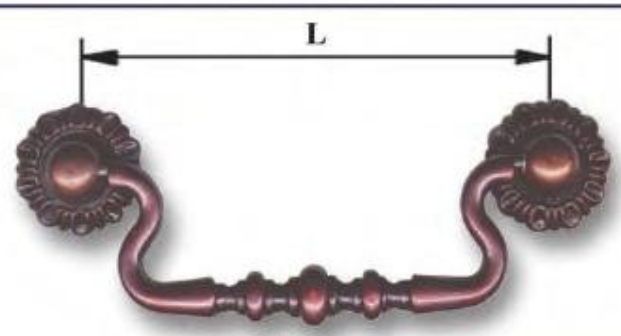

645-45 L=90



646-48 L=85



646-118/126 L=64/96



645-68 L=85



670-13 L=64



646-133 L=96



646-197/198 L=96



646-02 L=68



646-01 L=90



646-164 L=96



646-186 L=128



646-161 L=128



646-190 L=96



646-173/174 L=128/96



646-166/167 L=128/96



646-115 L=96

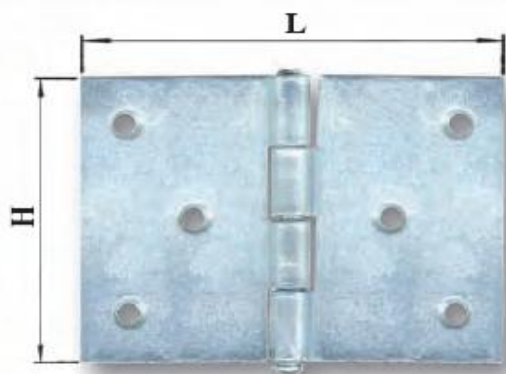

**290-81 (60X90)
(HXL)**



290-79 (60X70)



290-80 (60X50)



**290-87 (45X35)
290-88 (50X36)
290-93 (50X70)**



290-86 (50X40)



290-38 (50X40)



290-66 (36X20)



290-91 (25X50)



**291-04
(18X19)**

235-04/05



200-01 l=30

L = 1800



235-100/101



235-147/148



235-02



290-89

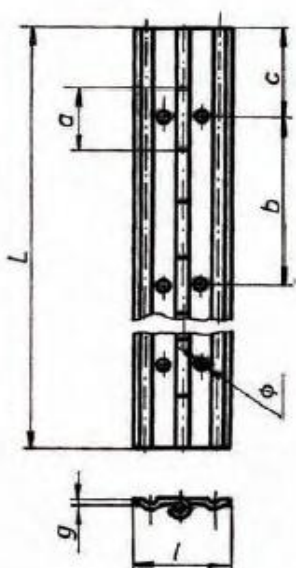

225-25



290-49



231-05



235-200



235-92



235-118



235-68



235-62



235-138



235-179

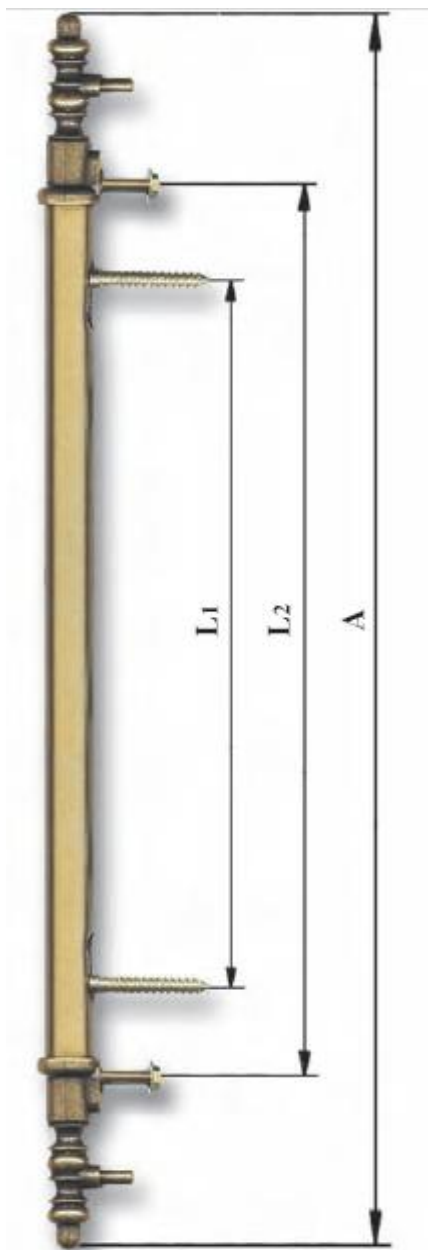

235-219 231

Balamale stil

COD	L1	L2	A
235-219	148	220	327
235-220	192,5	264,5	371,5
235-221	242,5	314,5	421,5
235-222	342,5	414,5	521,5
235-223	423	495	602
235-224	542,5	614,5	721,5
235-225	792,5	864,5	971,5
235-226	367,5	439,5	546,5
235-227	281	353	460
235-228	312,5	384,5	491,5
235-229	721	793	900
235-230	527,5	599,5	706,5
235-231	692,5	764,5	871,5

Balamale aruncator ϕ 35, ϕ 25



H=0 mm
H=2 mm



H=0 mm



H=15 mm



245-11



245-14



245-22/23



275-14



270-03 (30x140)



290-94 (50x200)



292-04



292-03



300-04



300-03/05

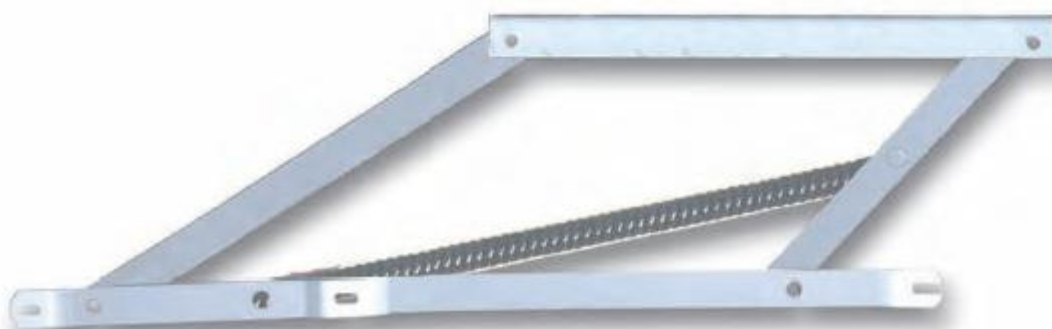

310-23

Balamale pentru canapele extensibile**270-54/55****270-32/33****270-10/11****270-25/26****270-60/61**



401-02



401-05



401-13



401-18



401-38



401-23



401-22



766-13.6



542-03



764-22



411-17



411-18



431-215 (M8) x 80



431-223/251/261..263/269 (M8)



431-106..115/25..28/117/147/278 (M6)



435-07



10000785 (M6)



10000792 (M8)



431-93/95 (M6)



431-143 (M8)



431-41 (M6)



431-256 (M6)



431-242 (M4)
410-03.06 (M6)



431-120-279 (M4/M5)
431-202/247 (M6)
431-101/281 (M8)



10000-793



435-14



784-01



431-01/02



431-286



431-198/199



431-293/294



410-29



410-33/35..37/51



450-10



450-16



450-31



450-35



450-05



450-09



785-139



450-10



450-16



450-31



450-35



330-17 (Ø22)



330-18 (Ø30)



330-78 (Ø43)



330-47 (Ø38)



330-73 (Ø43)



330-43 (Ø38)



10001301 (Ø40)



10001304 (Ø40)



10001303 (Ø40)



10001302 (Ø40)



10001307 (Ø50)



10001305 (Ø50)



10001308 (Ø50)



10001306 (Ø50)

Accesorii de susținere și ghidare



760-01
L=23



760-02
L=26



760-09 L=20
760-11 L=25



760-10
L=30



760-16
L=15,4



763-13



763-15



763-02



764-11/43



764-05



764-14



764-15



764-21



764-40



755-01



755-13



785-87



785-85



785-73



785-20



785-133
L=140



785-131
L=110
L=130



785-132
L=100



785-137
L=140



785-145
L=132



785-135



785-138

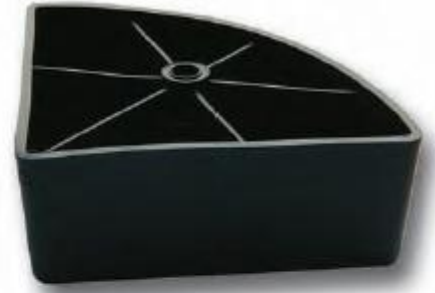

785-140



785-122 Extensie pentru canapele
varianta 10 L=1204 l=650
varianta 01 L=1410 l=650

785-125 Armătură pentru canapele



Balama stânga



Balama dreapta



Colțar cu rolă



Balama aripi inegale



Opritor cu bolț



Opritor



Rotilă



768-33



1008-29



1008-30

Șină de glisare cu role



L=250 mm, L=300 mm, L=350 mm
L=400 mm, L=450 mm, L=500 mm
L=550 mm

Șină de glisare cu bile



L=350 mm, L=550 mm



769-03



769-49



769-45



769-30



769-47



769-44



769-31



769-46



776-16 L=12 Ø=8
776-19 L=12 Ø=12

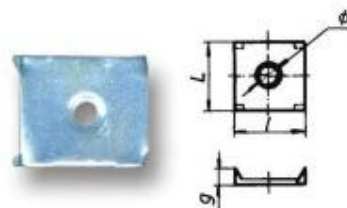

755-06 Ø=3 L=17 l=15 g=3,5
755-12 Ø=3,5 L=13 l=13 g=3

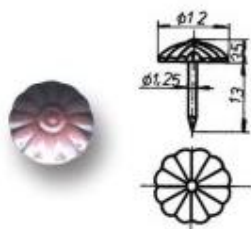

776-18



776-03

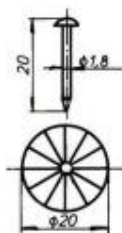

776-10

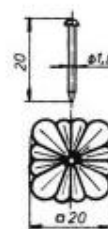

766-54



781-02



1200-32



1012-33